

1 FOUNDATION PLAN  
A-2 SCALE: 1/4"=1'-0"

- FOUNDATION PLAN NOTES:
1. ALL FOUNDATION WALLS TO BE CONCRETE ON GRADE.
  2. ALL FOUNDATION WALLS TO BE 12" THICK CONCRETE.
  3. ALL FOUNDATION WALLS TO BE 4" REINFORCED WITH #4 BARS @ 18" O.C.
  4. ALL FOUNDATION WALLS TO BE 4" REINFORCED WITH #4 BARS @ 18" O.C.
  5. ALL FOUNDATION WALLS TO BE 4" REINFORCED WITH #4 BARS @ 18" O.C.
  6. ALL FOUNDATION WALLS TO BE 4" REINFORCED WITH #4 BARS @ 18" O.C.
  7. ALL FOUNDATION WALLS TO BE 4" REINFORCED WITH #4 BARS @ 18" O.C.
  8. ALL FOUNDATION WALLS TO BE 4" REINFORCED WITH #4 BARS @ 18" O.C.
  9. ALL FOUNDATION WALLS TO BE 4" REINFORCED WITH #4 BARS @ 18" O.C.
  10. ALL FOUNDATION WALLS TO BE 4" REINFORCED WITH #4 BARS @ 18" O.C.

STATISTICS:	
AREA:	EXISTING: PROPOSED:
FIRST FLOOR AREA:	N/A 1,871 S.F.
SECOND FLOOR AREA:	N/A N/A
TOTAL LIVING AREA:	N/A 1,871 S.F.
BASEMENT AREA:	N/A 1,876 S.F.
GARAGE AREA:	N/A 480 S.F.
TOTAL AREA:	N/A 4,227 S.F.

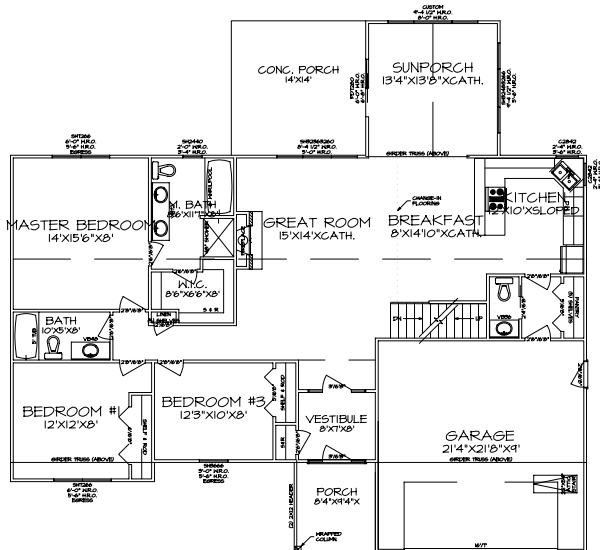

1 FIRST FLOOR PLAN  
A-3 SCALE: 1/4"=1'-0"

- FLOOR PLAN NOTES:
1. ALL INTERIORS TO BE 5/8" TYPE OF STC.
  2. ALL INTERIORS TO BE 5/8" TYPE OF STC.
  3. ALL INTERIORS TO BE 5/8" TYPE OF STC.
  4. ALL INTERIORS TO BE 5/8" TYPE OF STC.
  5. ALL INTERIORS TO BE 5/8" TYPE OF STC.
  6. ALL INTERIORS TO BE 5/8" TYPE OF STC.
  7. ALL INTERIORS TO BE 5/8" TYPE OF STC.
  8. ALL INTERIORS TO BE 5/8" TYPE OF STC.
  9. ALL INTERIORS TO BE 5/8" TYPE OF STC.
  10. ALL INTERIORS TO BE 5/8" TYPE OF STC.

GALLIVAN'S  
DRAFTING & DESIGN  
(217) 202-5998

1871SF1SB.dwg